



Redhawk



Serial #: 1UJLJCBM3R1XB4185
 Model: 24B REDHAWK MHC
 VIN#: 1FDXE4FN7RDD47109
 Model Year: 2024 Dealer Name: WORLD WIDE RV SALES
 5758 S WHITE MOUNTAIN BLVD
 LAKESIDE, AZ 85929
 USA

Manufacturer's Suggested Retail Price \$165,099.00

TOTAL AMOUNT DOES NOT INCLUDE STATE AND LOCAL TAXES OR LICENSE FEES. THE PRICES SHOWN ABOVE MAY VARY FROM THE BE REPRESENTATIVE OF THE ACTUAL SELLING PRICE OF SIMILAR RECREATIONAL VEHICLES IN YOUR AREA.

Standard Equipment

THE FOLLOWING ITEMS ARE STANDARD ON THIS MODEL AT NO EXTRA CHARGE

STANDARD EXTERIOR EQUIPMENT

- Ford® E-450 chassis
- GVWR- 14,500 lb.
- GCWR- 22,000 lb.
- 7.3L V-8 325 HP engine with 450 ft.-lb. torque
- 6-speed TorqShift® series transmission with overdrive
- 210-amp alternator
- Catalytic converter theft deterrent
- E-rated highway tires: LT225/75R16
- Tire pressure monitoring system (TPMS)
- Power anti-lock brakes with power steering
- 7,500 lb. hitch with 750 lb. tongue capacity and 7-pin plug
- 12V chassis battery
- 55 gal. fuel tank
- Swivel driver and passenger seats (24B, 26XD, 31F)
- Remote-controlled, side-view mirrors
- StrongholdVBL™ roof, floor and sidewalls
- Bead-foam insulation (R-24 max roof, R-9 max floor, R-5 max walls)
- TPO laminated roof
- Aluminum running boards
- Fiberglass exterior walls with vinyl graphics
- Leveling jack prep
- Frameless windows
- Remote keyless cab entry
- Entrance door with industry's largest travel-view window
- Electric-powered entrance step with integrated house battery compartment
- (2) high-output, marine-grade exterior speakers
- Slideout awning(s)
- Pass-through storage compartment with light (select models)
- Third brake light
- Roof ladder
- 4 in. bumper tube sewer hose storage
- Prep for satellite dish
- Cable TV hookup with RG-6 coax
- Digital antenna with signal booster
- 4,000W generator
- Solar prep
- 12V house battery
- Transfer switch with reverse polarity protection
- 30-amp electrical service
- 12.2 gal. propane tank (41 lb.)
- LP quick-connect hookup
- Exterior utility center
- Winterization drain system
- Outside shower
- 12V demand water pump
- Water filtration system

CUSTOMER VALUE PACKAGE

- Jride® Computer-balanced driveshaft, standard front and rear stabilizer bars, Helwig® helper springs, rubber isolation body mounts
- One-piece, seamless, fiberglass front cap
- Automotive-bonded, panoramic window in front cap with power shade
- Heated holding tanks (12V pads)
- Electric patio awning with LED lights
- Black holding tank sprayer
- Sony® infotainment center with Apple® CarPlay™ and Android Auto™
- Backup and side-view cameras
- LED HD Smart TV in living area

STANDARD INTERIOR EQUIPMENT

- Tilt steering wheel
- Cruise control
- Hill start assist
- Electronic stability control
- Traction control
- Auxiliary start switch
- Power windows and door locks
- Driver and passenger airbags
- Privacy curtain for cab area
- Overhead bunk with 750 lb. capacity and safety net
- 84 in. ceiling height
- High-intensity, recessed LED ceiling lights
- LED-lit slideout fascia
- Hardwood cabinet doors and drawer fronts
- Ball-bearing drawer guides
- Interior entrance door grab handle
- Interior command center
- Pleated blackout shades
- 15,000 BTU ducted A/C
- 30,000 BTU auto-ignition furnace
- Electric fireplace (26M)
- 6 gal. gas/electric DSI auto-ignition water heater
- Jayco-exclusive, easy-operation legless dinette table
- 2-point lap safety belts in all designated seating locations
- Car seat latches (select floorplans)
- 10 cu. ft. 12V refrigerator
- Furrion® all-in-one cooktop and oven
- Residential-size microwave
- Stainless steel kitchen sink
- Decorative kitchen backsplash
- Pop-up charging station with 120V outlet and USB plugs
- LED-lit pressed countertops
- Shower with decorative ABS surround and skylight
- Stainless steel bathroom sink
- Toilet with foot flush
- Vent fan in bathroom
- Queen-size bed with bedspread (24B, 26XD, 29XK, 31F)
- Queen-size power Murphy Bed (26M)
- USB port and wireless charging in nightstands (26XD, 29XK, 31F)
- USB port in cabinet over bed (24B, 26M)
- Under-bed storage (select models)
- Large wardrobes
- Bunks with industry-exclusive 300 lb. capacity each (31F)
- Smoke alarm
- Carbon monoxide detector
- Fire extinguisher

Optional Equipment

OPTIONAL EQUIPMENT INSTALLED ON THIS VEHICLE BY MANUFACTURER

Base price	163,293.00
MODERN FARMHOUSE USA STANDARDS	443.00
24 FD E45 14500 158* 7.3L WHITE RC10	n/c
CUSTOMER VALUE PACKAGE	6,000.00
HYDRAULIC AUTO LEVELING JACKS	n/c
200W ROOF MOUNTED SOLAR PANEL W/2ND INTERSTATE BATTERY**	893.00
INTERSTATE BATTERY FOLDING WINDSHIELD SUN SHADE	89.00
DINETTE	488.00
	n/c

UNIT TOTAL **165,099.00**

DEALER INSTALLED OPTIONS

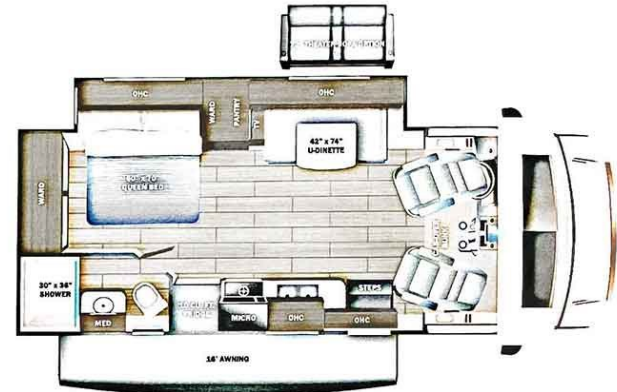

DIMENSIONS

Exterior height:.....138.00*
 Exterior width:.....100.00*

CAPACITIES

Fresh water tank (gals.)....42.50
 Gray water tank (gals.)....40.00
 Black water/toilet tank (gals.).....31.00
 Propane (lbs.).....41
 Propane (gals.).....9
 Water heater (gals.).....6.00

TIRES

Tire size (front):.....LT225/75R16E
 Tire size (mid):.....
 Tire size (rear):.....LT225/75R16E

Some dimensions may be rounded and may vary from the actual dimensions
 Weights may be estimated calculations and may vary from the actual weight - refer to the vehicle weight labels for actual weights
 Floorplans, features and specifications are subject to change without notice.

